



## Installation Guidelines

EOGas 3 sterilizer installation options

### Recommended Installation

Whenever possible, EOGas Sterilizers should be located near an outside wall, and exhaust directly to the outside via the included exhaust ventilator. AN 333 Sterilizers (shown) and AN310 Sterilizers on base cabinets have mounted casters providing convenient mobility.

#### Power Requirements:

Dedicated 230 V receptacle for EOGas 333 and EOGas 310.

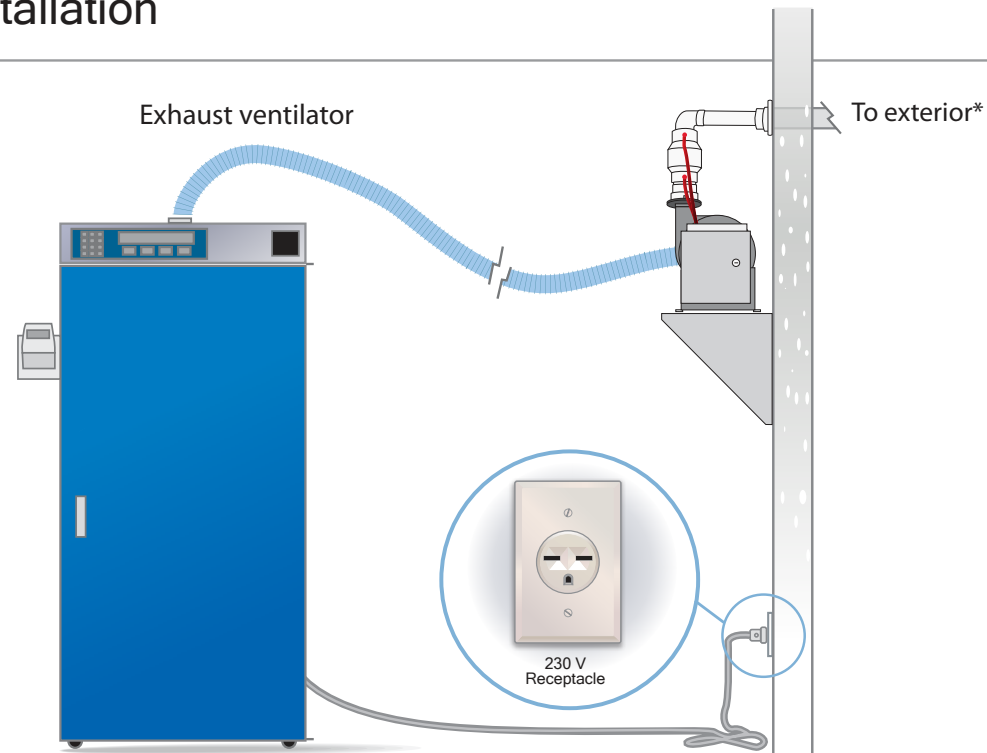

### Installation with Emissions Abator

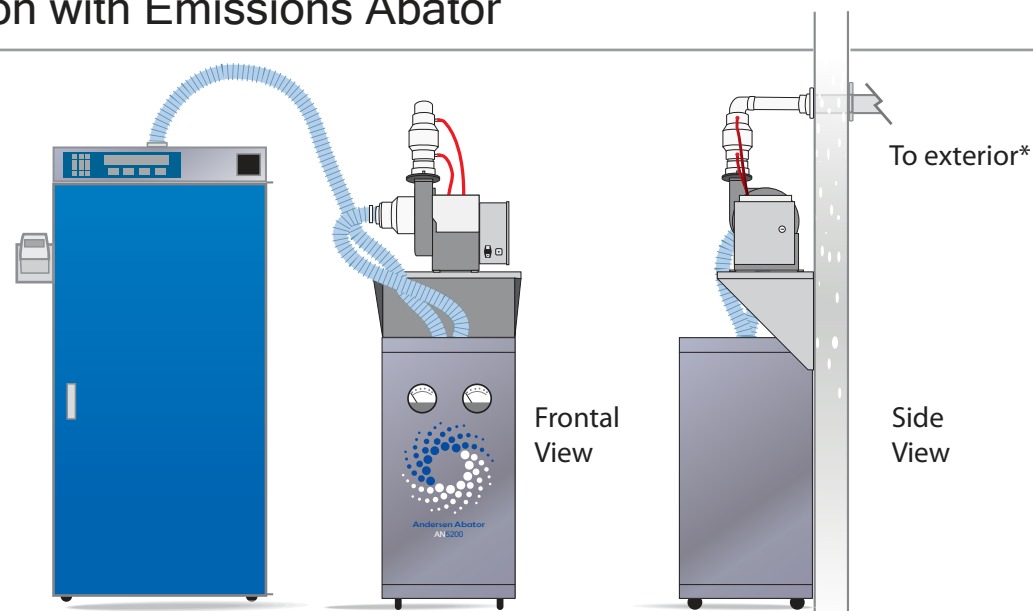

## Installation Guidelines

Alternative Installations to the Outside

### Recommended Configuration

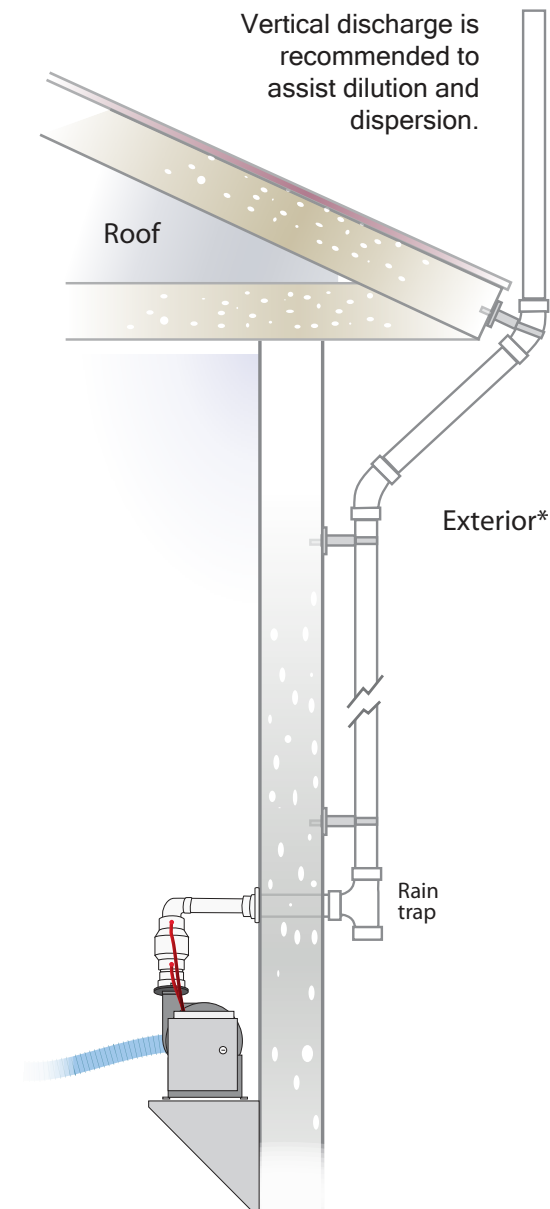

### Alternate Option 2

Roof installation with vent boot

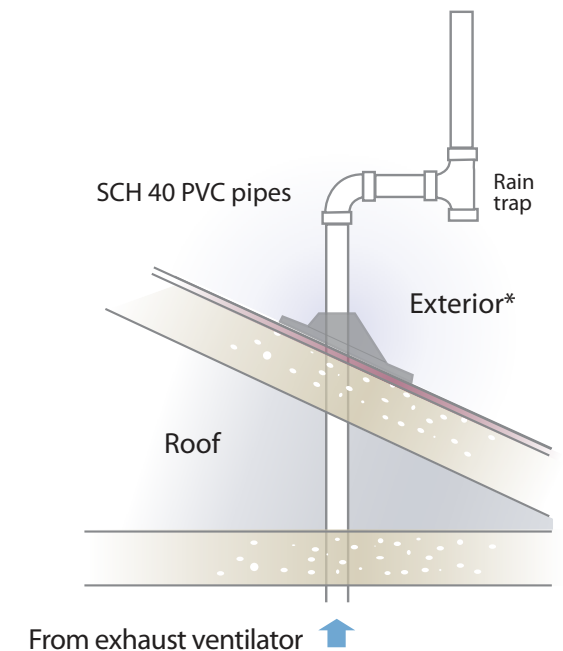

**\* Please note:** AAMI guidelines recommend that all EO sterilizers should be vented (exhausted) through a dedicated vent line to the outside atmosphere directly or through an emission control system. The vent should not terminate within 25 feet (7.6m) of any building air intake source or near pedestrian or animal traffic, nor should it allow EO release into or to reenter the building.

For further installation assistance please call your Andersen representative or 1.800.523.1276



Andersen Products, Inc.  
Health Science Park • 3202 Caroline Drive  
Haw River, NC 27258-9564 USA  
800.523.1276



**sterility.com**

Join Us: Follow, Like, Share



Distributed in Europe by: H.W. Andersen SARL  
Distributed in UK, Australia, Africa & Middle East by:  
H.W. Andersen Products, Ltd.  
anderseneurope.com